

Drinking water system Zip HydroTap® G4 B



Application areas

Drinking water supply for:

- > Domestic kitchens
- > Offices
- > Cafeterias / bistros
- > Restaurants / hotels



Drinking water system

Zip HydroTap® G4 B

Product information



boiling > G4 B 160

Part number:	4100-44278
Number of users:	< 50
Water connection (thread connection):	G ½" or G ¾" *
Rated pressure [bar]:	1.7 – 7.0
Boiling water temperature, adjustable [°C]:	68 – 100
Boiling water content [litres / cups ¹⁾]:	3 / 18
Boiling water capacity [cups ¹⁾ / h]:	160
Reheating time [cups ¹⁾ / min]:	2.6
Standby power consumption [kWh / 24h]:	0.50 ²⁾
Nominal power at voltage 1~ / N / PE 230 V AC [kW]:	1.9  with plug
Compact undersink unit [colour]:	white
Tap [surface material]:	chrome
Protection class:	IP20
Weight (filled) [kg]:	12
Dimensions (height × width × depth) [cm]:	33.5 × 28.0 × 31.3

*) Connection hose G ½" with supplied adapter G ¾" 1) Standard cup with 167 ml 2) At 12 hours in standby mode

Description

- > Undersink drinking water system, dispenses filtered, boiling hot water with the touch of a button
- > Electronic dispensing tap with lever operation, function indicators and safety lock for scalding protection
- > Touch display for menu navigation, for activating the energy saver modus and scalding protection as well as temperature setting of the water
- > Locking position of the levers for convenient filling without holding
- > Electronic temperature control
- > Easy-to-replace sub-micron particle filter cartridge with activated carbon filter, filters hazardous substances > 0.2 micron and improves the taste of water
- > Leakage protection system

Let your Zip HydroTap® G4 B helps you!

- > Preparing tea and filtered coffee
- > Sterilising containers
- > Quickly preparing instant soups
- > Blanching
- > Peeling fruits and vegetables
- > Dissolving grease
- > Removing candle wax

Drinking water system

Zip HydroTap® G4 B

Installation



Daily user requirements and the available space in the cabinet below the special tap should be considered when selecting the appropriate model.

Measurements in mm

Assembly and operating instructions must be observed upon installation.

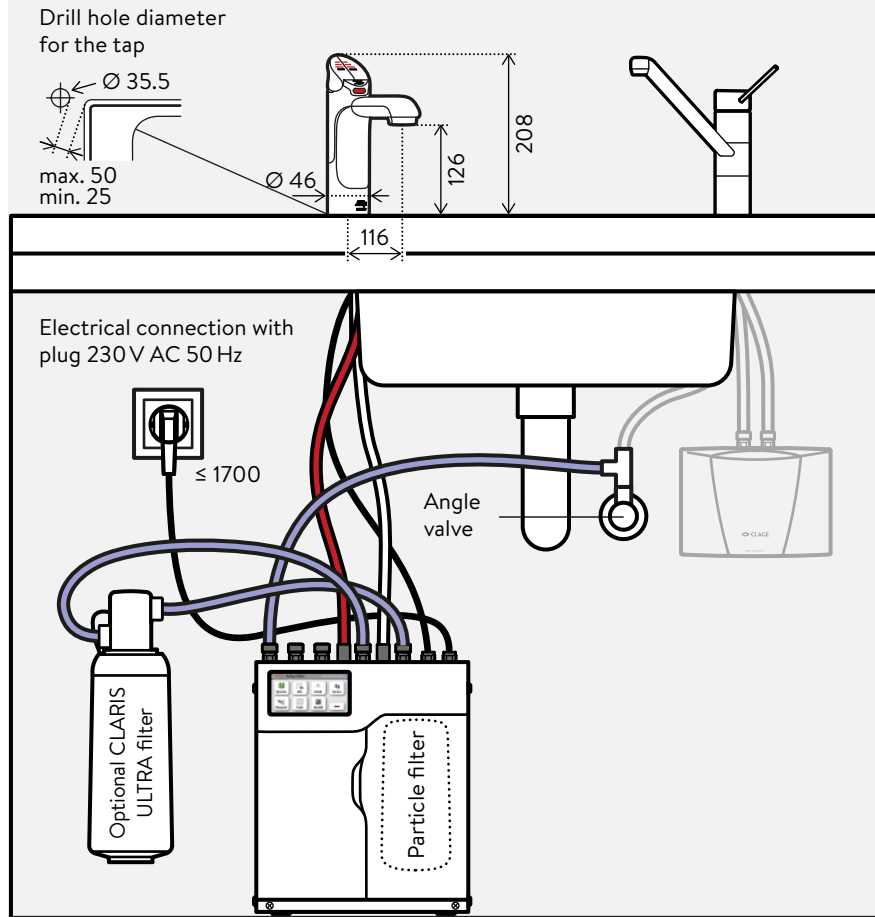

Unit dimensions:
(height × width × depth)

Zip HydroTap® G4 B 160
335 × 280 × 313 mm

Top clearance for undersink unit
(lower edge sink or drawers)
min. 200 mm

Right and left clearance for unit
min. 50 mm

Installation at the kitchen sink



Installation as stand-alone unit
with drainage front and extension KXTV.



Drinking water system

Zip HydroTap® G4 B

Accessories



KXF 2.1 (included)

Sub-micron particle filter cartridge filters contaminants > 0.2 microns and additionally improves the taste of the water.
For Zip HydroTap® G4 models since 02.2017.

KXF 2.1: Part no. 893702



Filter system CLARIS ULTRA for water softening (optional)

For hard, chalky water, the filter system CLARIS ULTRA is to be used (recommended from 10°KH).

Filter head suitable for all CLARIS ULTRA-filter

Filter head Universal: Part no. 84519

Filter cartridge, capacity at 10°KH 4.200 litre

CLARIS ULTRA 500: Part no. 84500

Filter cartridge, capacity at 10°KH 8.500 litre

CLARIS ULTRA 1000: Part no. 84501

Filter cartridge, capacity at 10°KH 20.000 litre

CLARIS ULTRA 2000: Part no. 84502



KXV (optional)

The optional chrome extension allows for raising the electronic dispensing tap by 10.7 cm.

Polished chrome (standard)

KXV10: Part no. 4100-44102



KXTV (optional)

The optional stainless steel font with drainage connection and chrome extension allows for flexible installation of the electronic dispensing tap at any location away from the sink.

Polished chrome (standard)

KXTV10: Part no. 4100-44111